



C.I./D.I. SLUICE VALVE FLANGED ENDS

innovations with a "difference"

Introduction:

A gate valve, also known as a sluice valve, is a valve which opens by lifting a round gate/wedge out of the path of the fluid. The distinct feature of a Sluice valve is the sealing surfaces between the gate and seats are planar, so Sluice valves are often used when a straight-line flow of fluid and minimum restriction is desired. The gate faces can be parallel, but are most commonly wedge-shaped.

Specification & Features:

- Combination of excellent design features.
- Rigid and sturdy design with minimum loss of head across the valve.
- Perfect interchangeability of components.
- Assured parallelism between side flanges.
- Assured equal taper between wedge rings.
- Perfect machining and pressing of body wedge rings.
- Excellent finish on spindle thread resulting in low friction and smooth operation of valves.
- Long service life and leak-tightness even after thousands of open/ close cycle.
- Standard machined for temper switch arrangement.

Applications:

Design Standard IS:14846.

Flanged Ends, Bolted Bonnet, Inside Screw, Non Rising Stem Handwheel Operated.

HYDRO TEST DETAIL

DN	50~300	
NOMINAL PRESSURE MPa	1.0 MPa	1.6 MPa
SHELL TEST MPa	1.5 MPa	2.4 MPa
SEAT TEST MPa	1.1 MPa	1.76 MPa
WORKING TEMPERATURE	<80 °C	
MEDIUM	Water, Waste Water	
MATERIAL	Ductile Iron	

www.lpvalves.com

ARTICLE NO.: LPV 1037



C.I./D.I. SLUICE VALVE FLANGED ENDS

innovations with a "difference"

Materials of Construction:

S.No.	PART NAME	Nos. Off	MATERIAL
1.	BODY	1	C.I./D.I.
2.	BONNET	1	C.I./D.I.
3.	STEM	1	13% Cr.
4.	GASKET	1	EPDM
5.	PACKING O' RING	4	NBR
6.	GLAND	1	C.I./D.I.
7.	STUFFING BOX	1	D.I.
8.	HANDWHEEL	1	D.I./M.S./Fab
9.	BOLT & NUTS	6	CARBON STEEL
10.	WEDGE RING	4	LTB-2/DCB
11.	WEDGE	1	D.I.
12.	WEDGE NUT	1	D.I.
13.	RING	1	NBR
14.	BOLT & WASHER	1	CARBON STEEL

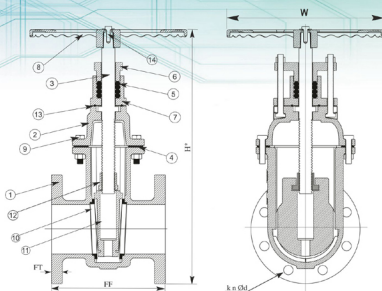

Colors Available:



k = P.C.D
n = No. of Holes
Ød = Dia. of Holes
H* = Height

Size/ Dimensions

Inches	MM	FF	ØFD	FT	K	n-Ød	H*	W _{PSD}	W _{PSD}
2"	50	178	165	19	125	4-19	365	225	280
2½"	65	190	185	19	145	4-19	380	225	280
3"	80	203	200	21	160	4-19	425	225	280
4"	100	229	220	22	180	8-19	470	320	360
5"	125	254	250	22.5	210	8-19	485	320	360
6"	150	267	285	23	240	8-23	595	320	360
8"	200	292	340	24.5	295	8-23	725	360	450
10"	250	330	395	26	350	12-23	835	400	640
12"	300	356	445	27.5	400	12-23	910	400	640

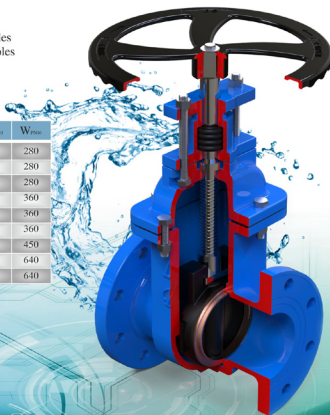

www.lpvalves.com

ARTICLE NO.: LPV 1037